

DESALTO

MIXIT GLASS

DESIGN ARIK LEVY



ISTRUZIONI DI MONTAGGIO
ASSEMBLY INSTRUCTION
MONTAGEANLEITUNG
INSTRUCTIONS DE MONTAGE
INSTRUCCIONES DE MONTAJE

MADE IN ITALY

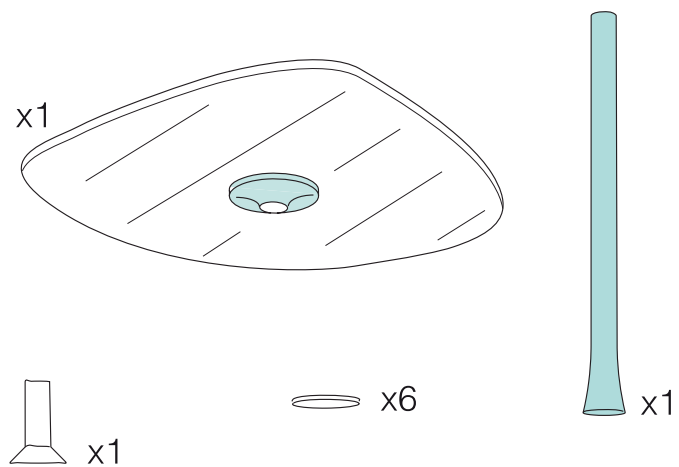

1A



1B

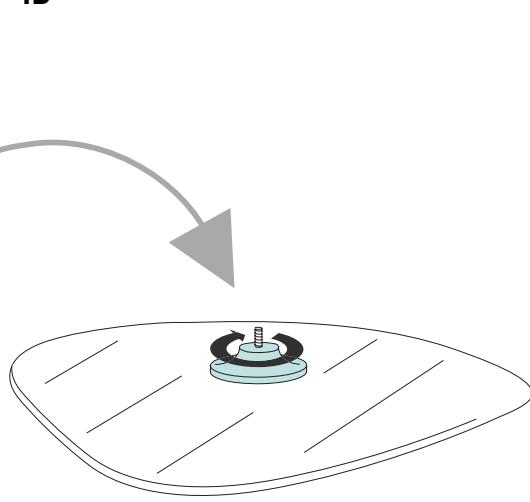

2

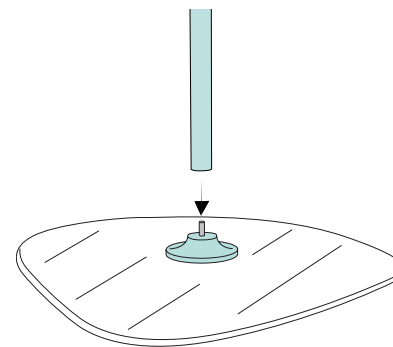

3

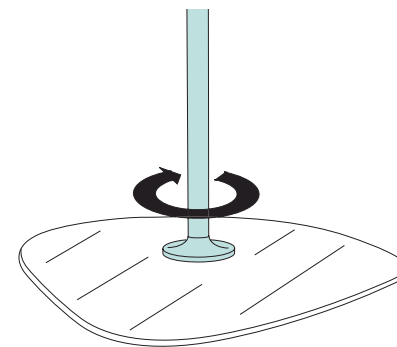

4

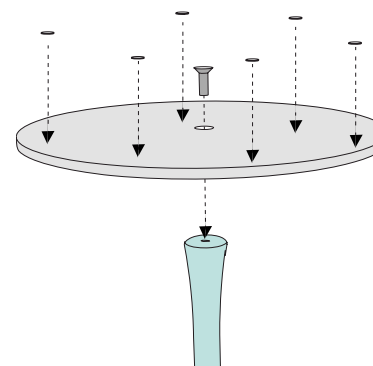

5

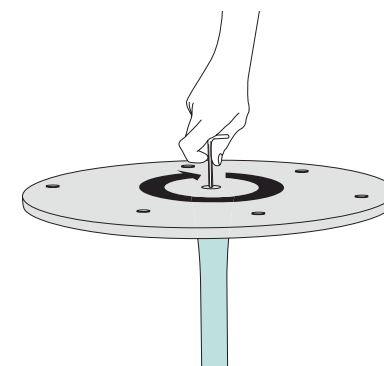

Applicare i gommini sotto la base.

Apply the rubber stoppers under the base.
Kleben die Gummi unter der Basis.
Appliquer les caoutchoucs sous la base.
Aplicar la goma debajo de la base.

Avvitare con forza la base.

Tighten the base strongly.
Verschrauben sie mit kraft die Basis.
Serrer avec force la base.
Tornillo con fuerza de la base.

DESALTO
VIA PER MONTESOLARO - C.P. 150
22063 CANTÙ (COMO) ITALY
TEL +39 031 7832211
FAX +39 031 7832290

INFO@DESALTO.IT
WWW.DESALTO.IT